

SALES DRAWING

SALES DRAWING

NO.	PART NAME	PART #	REQ'D	MATERIAL
1	PLUG 3"	TC3316P	1	316 SS
2	CHAIN ASSEMBLY	CH2316PA	1	304 SS

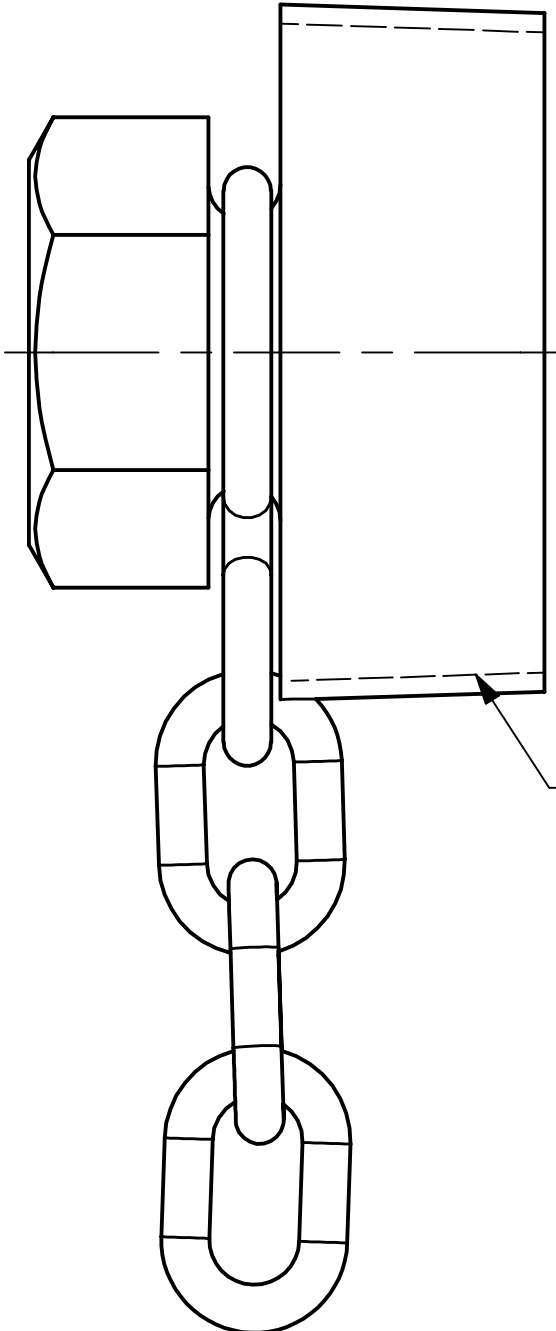
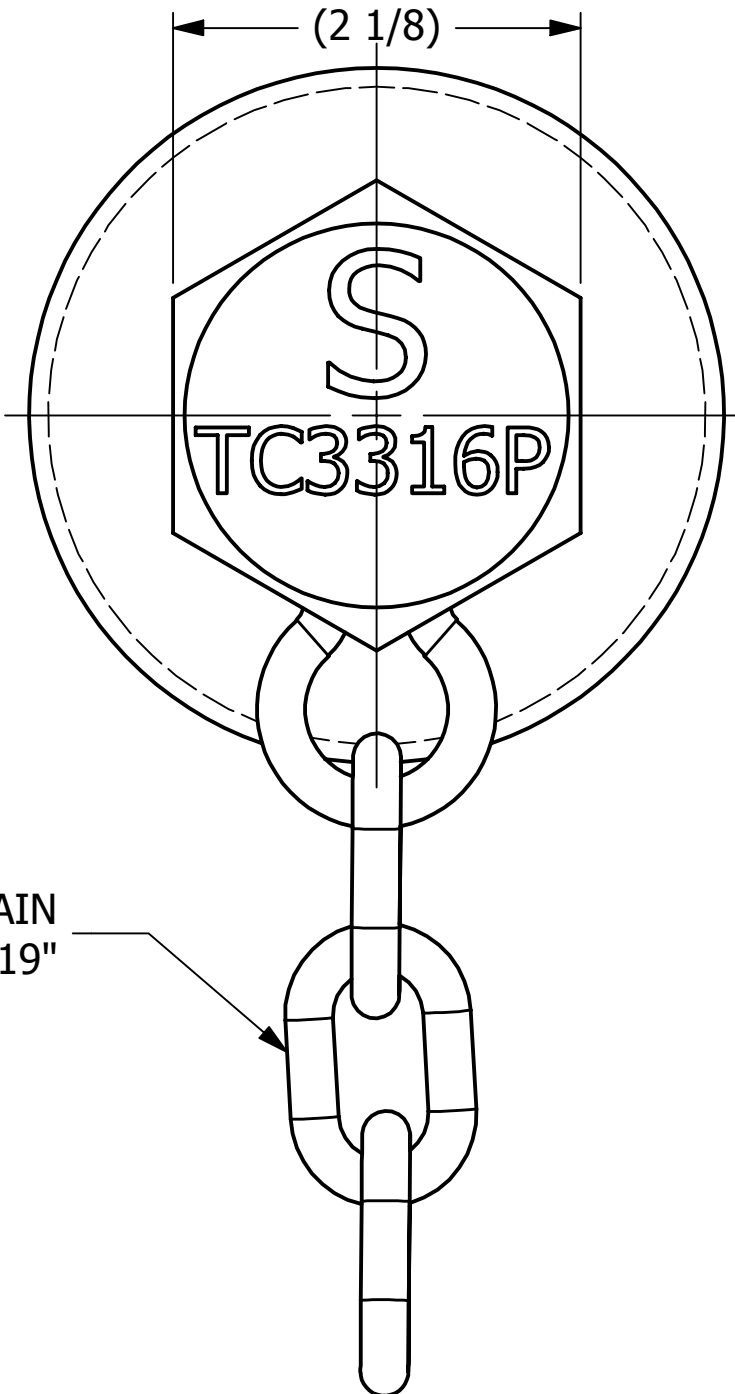

15 LINKS OF 1/4" SS CHAIN  
APPROXIMATE LENGTH IS 19"

3-8 NPT

REV	BY	DATE	DESCRIPTION
D	REH	3-10-10	UPDATED DRAWING
C	ACC	1-13-99	CHAIN MATERIAL WAS 316 SS
B	MRC	5-20-97	CHAIN DIAMETER WAS 3/16"
A	BRW	2-8-96	REMOVED MACHIN OPERATION

<small>UNLESS OTHERWISE SPECIFIED DIMENSIONAL TOLERANCES</small> FRACTIONAL: ±1/16 X.XX: ±.03 X.XXX: ±.015 ANGULAR: ±1° <small>DEBURR ALL SHARP EDGES. ALL MACHINED SURFACES TO HAVE A 125 RMS FINISH UNLESS NOTED OTHERWISE.</small> <small>THIRD ANGLE PROJECTION</small>	DRAWN BY:	ACC
	CHECKED BY:	
	PROTOTYPE BY:	ACC
	PROTOTYPE DATE:	9/14/1995
	APPROVED FOR PRODUCTION BY:	ACC
	PRODUCTION DATE:	9/14/1995

<b>SALCO PRODUCTS, INC.</b>		
PART NAME: <b>PLUG ASSEMBLY 3"</b>		
MATERIAL: <b>STAINLESS STEEL</b>		
PROJECT #:	SHEET #: <b>1 OF 1</b>	SCALE: <b>1:1</b>
DRAWING #: <b>B7641</b>	PART #: <b>TC3316PA</b>	

THIS PRINT, PROPERTY OF SALCO PRODUCTS INC., CONTAINS PROPRIETARY INFORMATION AND MUST NOT BE COPIED, REPRODUCED, OR USED DETRIMENTALLY TO OUR INTEREST.